

## End Clamp 28-46mm with M module, Length 50mm

### Assembly

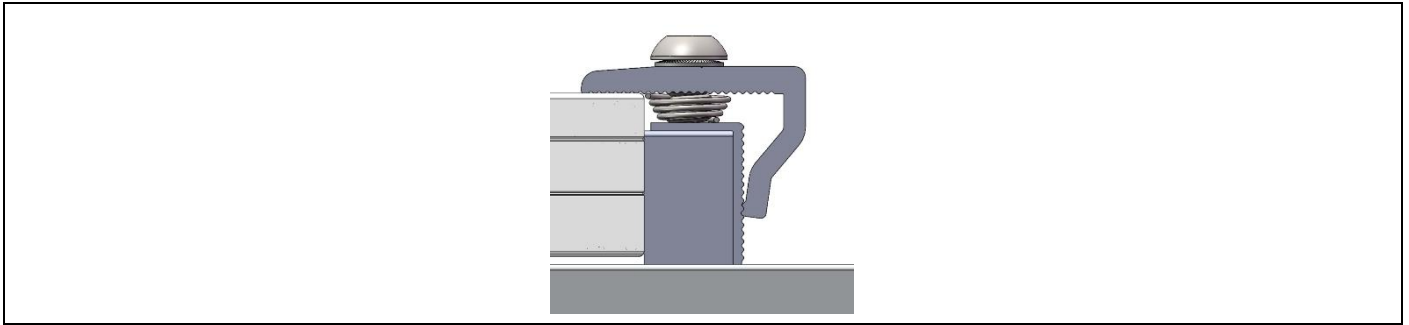

### Component

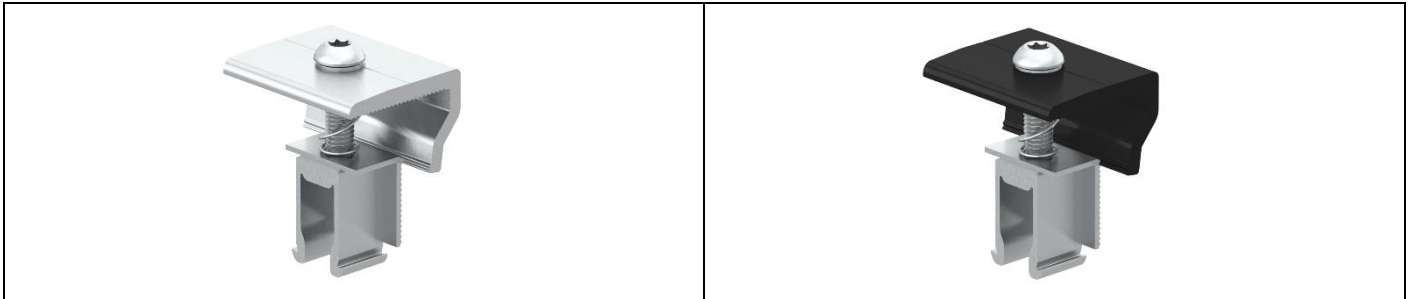

End Clamp 28-46mm with M module, Length 50mm  
 Part No.: EC-M28-46/L50 (bar code: 10-006-0198), EC-M28-46/L50/BA (bar code: 10-006-01895)

### Technical Specification

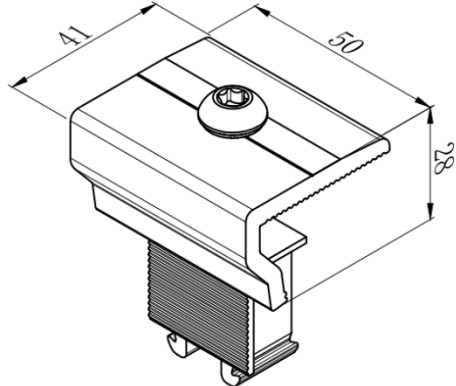
<b>Application</b>	For framed PV Modules of 28-46mm in height	
<b>Requirement</b>	Needs 18mm space on each side of the Rail	
<b>Dimensions</b>	L50mm*W41mm	
<b>Weight</b>	0.0705 Kg	
<b>Packaging</b>	75 units per pack, 4 packs (300 units) per carton	
<b>Material</b>	Main parts: AL6005-T5 Bolts/Washers/Springs: SUS 304	
<b>Finish</b>	EC-M28-46/L50 : Anodised (no less than 10 µm, excluding machined surfaces) EC-M28-46/L50/BA: Anodised (no less than 10 µm)	
<b>Standard</b>	GB50797   AS NZS1170.2-2011   EN1991   JISC8955   ASCE 7-10	