

Accessories

Accessories - Brackets for inverter / combiner box

EZ-UB-STIIIA



SolarTerrace III-A, Bracket kit for Inverter / Combiner Box

- U-Fixing Bracket for Tube 60 x 60mm (2-23/64" x 2-23/64")
- T-head bolt M8 x 25mm (5/16" x 63/64")
- Plain washer large 8 x 24mm (5/16" x 53/64")
- Washer 8mm (5/16")
- Hexagon nut M8 (5/16")
- Self-drilling screw ST6.3 x 25mm (1/4" x 63/64")

EZ-UB-STIIA



SolarTerrace II-A, Bracket kit for Inverter / Combiner Box

- U-Fixing Bracket for Tube 60 x 60mm (2-23/64" x 2-23/64")
- T-head bolt M8 x 25mm (5/16" x 63/64")
- Plain washer large 8 x 24mm (5/16" x 53/64")
- Washer 8mm (5/16")
- Hexagon nut M8 (5/16")

EZ-RT-60/60/740



Slotted Al-Tube for Bracket kit for Inverter / Combiner Box

- Slotted Al-Tube 60 x 60 x 740mm (2-23/64" x 2-23/64" x 2' 1-13/64")

ER-R-C41/61/800



C-Channel for Bracket kit for Inverter / Combiner Box

- 41 x 62 x 800mm (1-39/64" x 2-7/16" x 2' 7-1/2")

Accessories - Rubber pads

EZ-RB-65/45/12

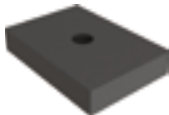

EPDM rubber pad

- EPDM rubber pad 65 x 45 x 12mm (2-9/16" x 1-49/64" x 15/32")

EZ-RB-ST



Rubber Pad

- 50 x 25 x 2.2mm (1-31/32" x 63/64" x 3/32")

EZ-RB-65/20000/2



EPDM strip

- EPDM strip 65 x 20000 x 2mm (2-9/16" x 65' 7-13/32" x 5/64")

Accessories - Other

EZ-AD-C110



SolarRoof Adapter for Corrugated Iron Roof

- AL Adapter 110mm x 124mm (4-21/64" x 4-7/8")
- EPDM rubber pad
- Z-Module and bolt

EZ-CD-102



Isolator Bracket

- Isolator Bracket
- Hexagon Socket Head Bolt M8 x 25mm (5/16" x 63/64")
- Z Module L20
- Spring Washer M8 (5/16")
- Flat Washer M8 (5/16")

EZ-AD-GSS76/CP140



Adapter between Ground screw S76 and C-Post 140

- U-Profile Bracket
- Arc Fixed Block
- Hexagonal bolt M12 x 120mm (15/32" x 5-1/64")
- Washer 12mm (15/32")
- Plain washer 12mm (15/32")
- Hexagon nut M12 (15/32")

EZ-RE-200



Roof Hook Extender

- 200mm Roof Hook Extender
- Hex Socket Head Bolt
- Hex Nut

ER-R-MT/2560



MT-rail

- With a standard length of 2560mm (8' 4-25/32")

EZ-Z-STBW



Z-Module assembly with bolt and washer

- Z-Module
- M8 x 25mm (5/16" x 63/64") A2 70
- Washer 8.4mm (21/64") DIN 9021 A2
- Lock Washer 8mm (5/16") A2

ER-DM-MT8



Diamond module M8 with Hexagon Socket bolt M8x20 (for AU)

EZ-Z-ST



Z-Module